

# Domlock installation

read before use and contact the supplier if you are unsure

## Part One: Fastening the alloy base.

1. The base of the Domlock must be fully supported by a structural rail.
2. The “Jaw” of the aluminium faces toward the film being fastened.
3. Fasten with screws not more than 225mm apart\* (use screw type to suit the structural rail – e.g timber, steel, alloy, etc).
4. Take care to align the alloy joints and leave a 2mm expansion gap between the ends of the base part.



## Part Two: Tensioning the film over the aluminium jaw & sition the first channelinsert.

5. Tension the film over the jaw of aluminium.
6. Insert the strip beginning at their ends.

Leave a small gap between strips 5-10mm to allow for heat expansion.  
Check that the channel is fully “open” in readiness for the bead insert.

## Part Three: Install the Locking Bead

8. Ensure that the channel is fully seated & that the Jaw of the channel is fully open before pressing the locking bead into place.
9. Press one end of the locking bead with its rounded edge facing down fully into position. A soft headedmallet may be used gently to assist the rest of the bead strip into place.

NOTE: The locking bead must be a tight fit (not easily removed by hand). If in doubt, add additional layers of material beneath the channel to “tighten” the fit.

10. Trim off Excess Plastic leaving a 75-100mm Tail, to allow for shrinkage and any later adjustments required.

## IMPORTANT REMINDER NOTES!

The position of the film, the direction of the channel insert, the full seating & opening of the channel before the bead insertion is essential for reliable holding and to prevent damage of the Film.

**Do not** place the cover between the two inserts! Always assemble the two inserts in two stages.

If removal of the strips is required **always** remove the locking bead firstly then pull the trailing edge of the film. Removal of channels in any other way can result in damage to the film or alloy base.

If the locking bead feels loose when fitted, - please insert an additional layer of film to tighten the system

The locking bead and channel must be offset and not start and finish at the same points

**Note: The inserts will shrink and expand with heat. Please make sure to leave a small gap between strips 5-10mm to allow for expansion. Failing to do so may result in the inserts pushing out.**



**TIP** - When fixing the aluminum base to a steel rail, start with a slow drill speed. Once through the aluminum, increase the drill speed to penetrate the steel rail.  
Do not over tighten

# Domlock installation - Picture Guide

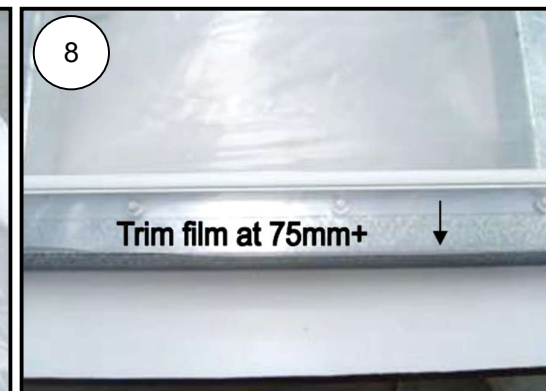
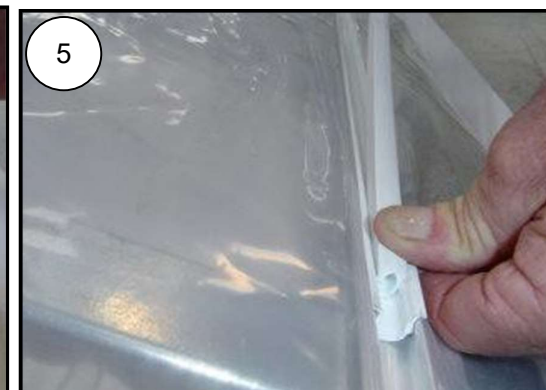
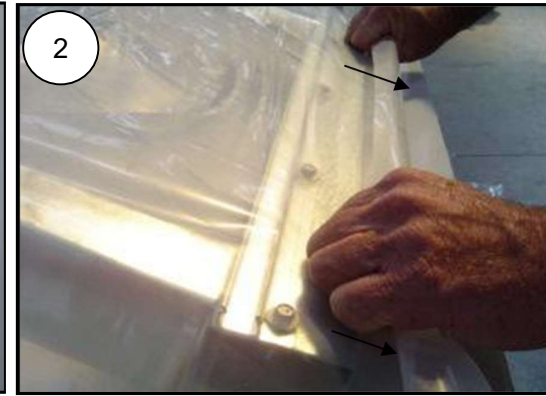
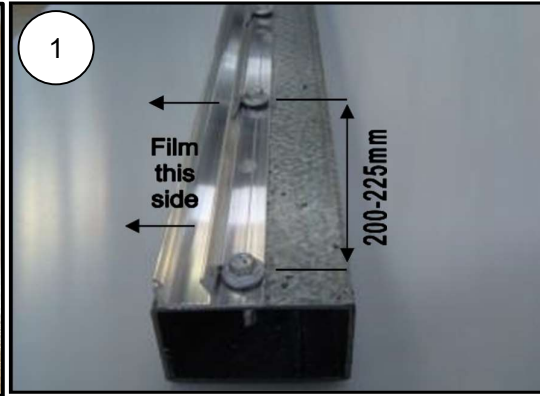
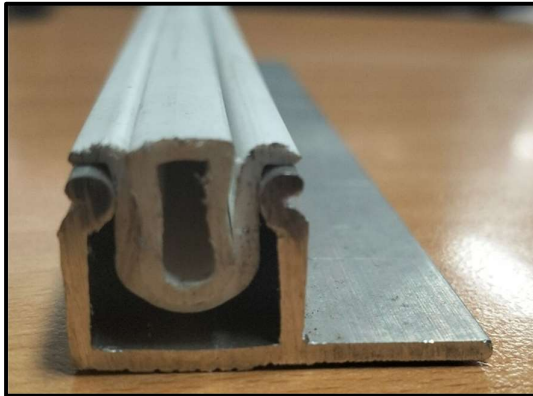

1. Screw Spacing
2. Pull the film tight over the aluminium jaw.
3. Important: Fully seat the channel insert & spread its jaw fully open
4. Position the locking bead with the rounded edge facing down.
5. With the channel fully spread, press the locking bead into place, beginning at its end. (It should be a firm fit)
6. Insert the bead fully making sure that it feels "tight" (cannot be removed easily by hand)
7. Completed view
8. Completed view (2) Trim the rear facing part of the cover at 75mm